

EasyPhos

Quick Start Guide



Installazione
Installation

www.mantaecologica.com

Ad ogni smontaggio
mantenere gli O-Ring
LUBRIFICATI con grasso
siliconico.

At each disassembly,
maintain the O-Rings
lubricated with silicone
grease.

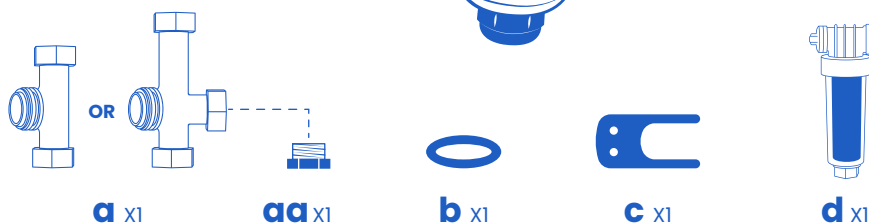
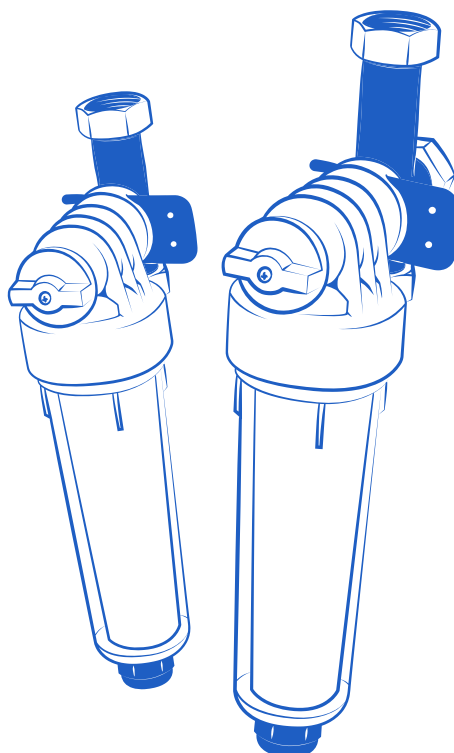

Installazione - Installation

Manutenzione - Maintenance

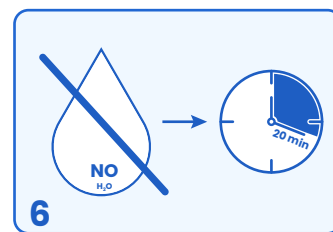
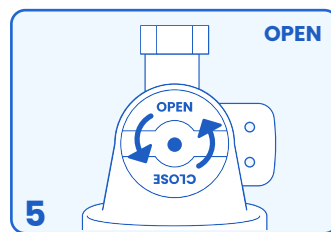
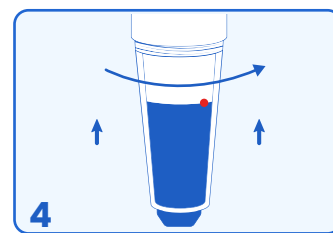
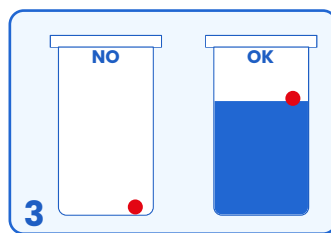
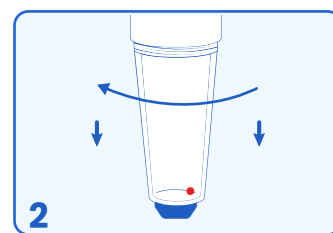
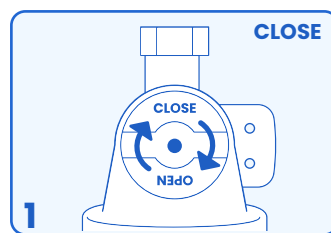
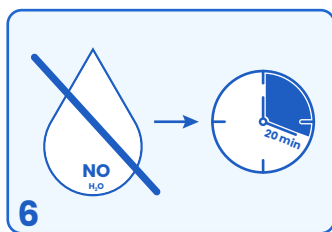
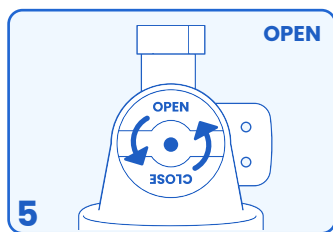
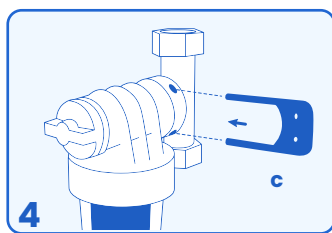
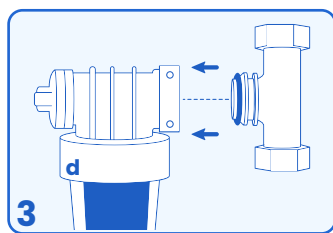
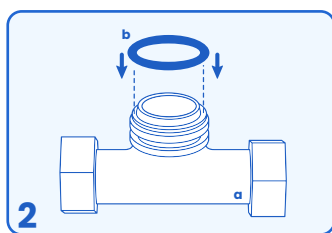
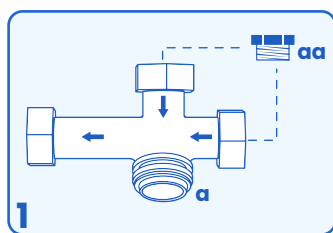

Garanzia a Vita

La garanzia copre a vita tutti i difetti di fabbrica.

Rimane valida effettuando la normale manutenzione del filtro: sufficiente sostituire la cartuccia annualmente secondo quanto previsto dal manuale e registrarne l'acquisto.



Scansiona il QR-Code

Scopri tutte le informazioni

Lifetime Warranty

The warranty covers all manufacturing defects for life.

It remains valid provided regular maintenance of the equipment is carried out: simply replace cartridges and consumables annually as specified in the manual and register the purchase of the consumable.



Scan the QR code

Discover all the information

Dati Tecnici / Technical Data

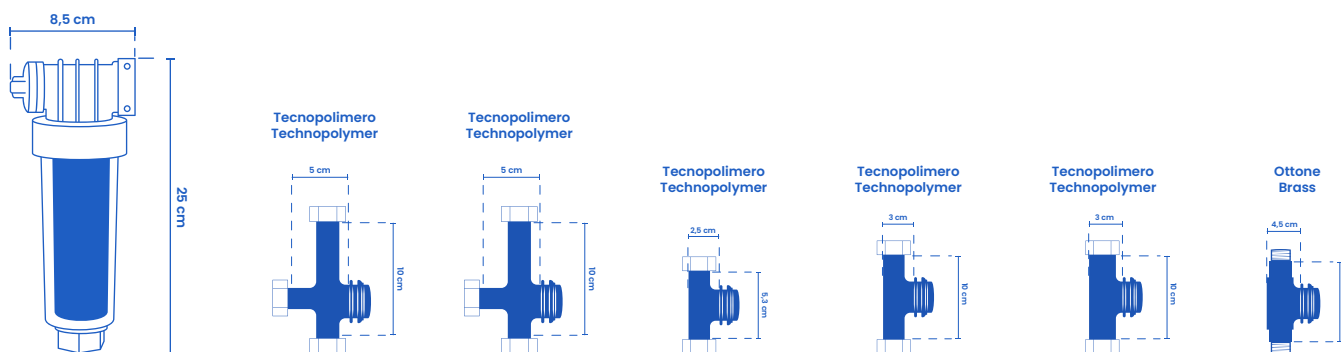

| Raccordi In/Out - Fittings In/Out | IN 1/2" F OUT 1/2" F | IN 3/4" F OUT 3/4" F | IN 1/2" F OUT 1/2" F | IN 3/4" F OUT 3/4" F | IN 1" F OUT 1" F | IN 3/4" F OUT 3/4" F |
|---|---------------------------------------|---------------------------------------|---------------------------------------|---------------------------------------|---------------------------------------|---------------------------------------|
| Pressione Max. - Max Pressure | 6 bar | 6 bar | 6 bar | 6 bar | 6 bar | 6 bar |
| Filtrazione - Filtration | 90 µm | 90 µm | 90 µm | 90 µm | 90 µm | 90 µm |
| Portata - Flow Rate | 2 m ³ /h (ΔP 0.2 bar) | 3 m ³ /h (ΔP 0.2 bar) | 2 m ³ /h (ΔP 0.2 bar) | 3 m ³ /h (ΔP 0.2 bar) | 3,5 m ³ /h (ΔP 0.2 bar) | 3 m ³ /h (ΔP 0.2 bar) |
| Temp. ambiente - Ambient temperature | 5-40 °C | 5-40 °C | 5-40 °C | 5-40 °C | 5-40 °C | 5-40 °C |
| Uso - Use | Potabile Tecnico Potable-Technical | Potabile Tecnico Potable-Technical | Potabile Tecnico Potable-Technical | Potabile Tecnico Potable-Technical | Potabile Tecnico Potable-Technical | Potabile Tecnico Potable-Technical |
| Materiale - Material | PA-SAN-PE | PA-SAN-PE | PA-SAN-PE | PA-SAN-PE | PA-SAN-PE | PA-SAN-PE |
| Autonomia - Refill Capacity | 130 m ³ /h | 130 m ³ /h | 130 m ³ /h | 130 m ³ /h | 130 m ³ /h | 130 m ³ /h |
| By-pass integrato - Integrated bypass | Si / Yes | Si / Yes | Si / Yes | Si / Yes | Si / Yes | Si / Yes |
| Dosaggio inferiore al. - Dosage Less Than | 5 mg/L | 5 mg/L | 5 mg/L | 5 mg/L | 5 mg/L | 5 mg/L |

Store Manta Ecologica



SE NON TROVI LE RICARICHE DAL TUO FORNITORE DI FIDUCIA, PUOI ACQUISTARLE SUL NOSTRO STORE

www.mantaricariche.it



Applicable only in Italy