

EasyDos

PROPORTIONAL HYDRODYNAMIC POLYPHOSPHATE DOSER



USER MANUAL

INDEX

1.0 General warnings and Information for the recipient.....	04
1.1 EC Declaration of conformity	04
1.2 General Warnings and information for the recipient	04
1.3 Lifetime Warranty	05
1.4 Safety Warnings	07
2.0 Technical Data and Specification.....	08
3.0 Initial installation	09
4.0 Maintenance	11
5.0 Your Contribution to Enviromental Protection	12
5.1 Packaging Disposal	12
5.3 Product and Cartridge Disposal.....	12

1.0 GENERAL WARNINGS AND INFORMATION FOR THE RECIPIENT

1.1 EC Declaration of Conformity

Manta Ecologica S.r.l.

Viale Archimede n. 45 - 37059 – Santa Maria di Zevio (VR)
Tax information: VAT: 00780420964 – REA Number: MB
1014132

DECLARES

As required by the Italian Ministry of Health Decree of 7 February 2012, No. 25, that this article (Easy Dos) complies with the provisions of D.M. 6 April 2004, No. 174, and meets the requirements and standards referred to in Article 3, letters a), b), c), d) of the above-mentioned D.M. 25/2012.

1.2 GENERAL WARNINGS AND INFORMATION FOR THE RECIPIENT

Domestic-use equipment for the treatment of drinking water

«Warning: this equipment requires regular periodic maintenance in order to ensure the drinking water quality standards are maintained and to preserve the improvements as declared by the manufacturer ».

Location: Santa Maria di Zevio
(VR)

Date: 09/03/2026

The Administrator – Luca Cavalli



1.3 LIFETIME WARRANTY

How it works:

It is a lifetime warranty covering manufacturing defects.

All production defects (i.e. manufacturing non-conformities) are covered.

The following are not covered: consumable materials and wear and tear (e.g. O-rings, seals), labour costs for replacement, installation defects, improper use, failure to carry out maintenance, or damage caused by force majeure.

The lifetime warranty remains valid provided that routine maintenance of the equipment is carried out regularly, i.e. by replacing refills/consumables according to the intervals specified in the manual and registering the purchase of the consumable on the Easy Warranty portal, available at: www.garanziamanta.it

The cartridge must be replaced at least once a year, as detailed on page 11.

In the event of a confirmed manufacturing defect, we will replace the Easy unit or its defective component with a new one.

WHERE TO PURCHASE CONSUMABLES AND REFILLS

From your trusted supplier

Purchase refills and consumables from your trusted supplier.

To maintain the warranty, simply register the purchase of the consumable on the Easy Warranty portal at: www.garanziamanta.it

On the portal, you must register the installation of the refill or consumable by entering the serial number, which can be found on the silver label on the device.

Manta Ecologica online store

Refills can be purchased directly from the Manta e-commerce store:
www.mantasticariche.it

- By entering the device serial number at the time of order, the product warranty is extended by one year for each refill purchased.
- By entering the discount code provided by your retailer, you will receive a 10% discount on the list price.

1.4 Safety Warnings

Read the user instructions carefully:

Strictly observe the specified usage limits. Do not store or install in freezing conditions or near excessive heat sources. Do not use with liquids other than water or at temperatures above 40 °C. Store in a dry place. Protect the product from moisture in the air. If the pressure exceeds 6 bars, install a suitable pressure reducer upstream of the composite filter. Before installing the product, ensure that the plumbing system has been carried out in accordance with current best practices.

Product Description:

The Easy line dosers are devices designed and manufactured to treat water in plumbing systems (domestic and industrial use) with a quantity of natural food-grade mineral salts for a maximum dosage of 5 ppm, in order to provide anti-scale and anti-corrosion protection. There is no risk of overdosing, as the dosing is proportional to the flow, in compliance with the limits set by Legislative Decree 18/2023 on water intended for human consumption.

This chemical water conditioning treatment complies with the provisions of D.M. No. 37 of 22/01/2008, as well as the UNI-CTI 8065 technical standard for water treatment in heating systems and domestic hot water production.

The doser prevents calcium and magnesium salts present in the water from quickly depositing and clogging taps, pipes, domestic appliances, boiler coils, wall-mounted boilers, etc., and protects installations from corrosion by creating a protective film inside the pipes.

2.0 TECHNICAL DATA AND SPECIFICATIONS

EN

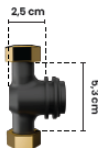
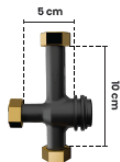

EasyDos 3 Way

IN/OUT FITTINGS	IN 1/2" F - OUT 1/2" F
MAX PRESSURE	6 bar
FILTRATION	90 µm
FLOW RATE (ΔP 0,2 BAR)	2 m³/h
AMBIENT TEMPERATURE	5 - 40 °C
USE	Potable/Technical
MATERIAL	PA-SAN-PE
REFILL CAPACITY	45 m³/Refill
INTEGRATED BYPASS	Yes
SHUNT FILTRATION	Yes
DOSAGE LESS THAN	5 mg/L

EasyDos Line

IN/OUT FITTINGS	IN 1/2" F - OUT 1/2" F
MAX PRESSURE	6 bar
FILTRATION	90 µm
FLOW RATE (ΔP 0,2 BAR)	2 m³/h
AMBIENT TEMPERATURE	5 - 40 °C
USE	Potable/Technical
MATERIAL	PA-SAN-PE
REFILL CAPACITY	45 m³/Refill
INTEGRATED BYPASS	Yes
SHUNT FILTRATION	Yes
DOSAGE LESS THAN	5 mg/L

3.0 INITIAL INSTALLATION

The doser can be installed:

- At the entry point of the exchangers (boilers, water heaters)

IMPORTANT

The polyphosphate doser ensures high efficiency against limescale for the water hardness up to approximately 25-30°F.

It is recommended to install a water softener in combination with the doser

WARNING!!!!

- Do not use hemp on the threads.
- During assembly, tighten by hand only; do not use a pipe wrench.
- When replacing the filter and/or doser, slowly restore the water flow to avoid high pressure that could damage the equipment.

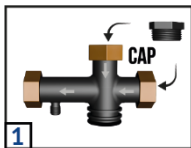

Adapt the connection to the installation by closing any unused inlet, following the arrows for the water flow.

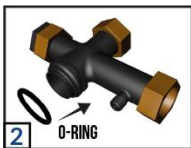

Place the O-ring on the fitting and connect the Easy Dos body with a slight rotation.

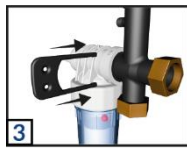

Insert the doser and secure it with the fork clamp.

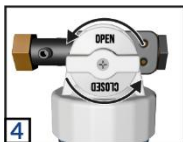

Slowly turn the knob to OPEN

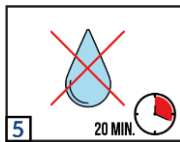

Wait 20 minutes before using the water.

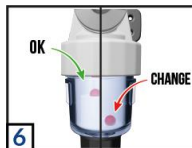

If the red ball is at the top: cartridge is operating
If the red ball is at the bottom: cartridge needs replacing.

4.0 MAINTENANCE – CARTRIDGE REPLACEMENT

The mineral salt cartridge must be replaced when it is exhausted. When the cartridge is spent, the red ball will be at the bottom.

1. Turn the knob to CLOSED.
2. Unscrew the housing.
3. Remove the old cartridge and insert the new one.
4. Screw the housing back on by hand until slight resistance is felt; do not overtighten.
5. Slowly turn the knob to OPEN.
6. Wait 20 minutes before using the water.

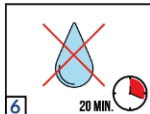
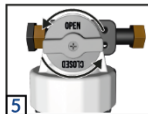
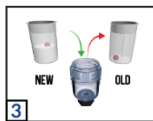
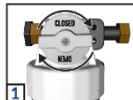

5.0 YOUR CONTRIBUTION TO ENVIRONMENTAL PROTECTION

1.1 Packaging Disposal

The packaging protects the product from damage during transport. The materials used for packaging have been selected based on environmental friendliness and ease of disposal and are therefore recyclable.

Returning the packaging to the materials recycling stream helps save raw materials and reduces waste volume.

1.2 Product and Cartridge Disposal

The user must dispose of the device at the end of its life in the appropriate bins for separate waste collection.

The cartridge is considered non-recyclable dry waste, whereas the head can be disposed of with plastic materials.

Proper separate collection, treatment, and environmentally compatible disposal help prevent potential negative impacts on the environment and health, while promoting the recycling of the materials the device is made from.



Illegal disposal of the product by the user may result in administrative fines as provided by current regulations.



Manta Ecologica S.r.l.

Viale Archimede, 45 - 37059 Zevio (VR) - Italy

Tel. +39 0458731511 - e-mail: info@mantaecologica.com

www.mantaecologica.com